

## INSTALLATION INSTRUCTIONS

DESCRIPTION: Rock Slider Kit  
PART NUMBER: B4J-F11D0-V0  
MODEL: 2021+ Wolverine RMax4



### ⚠ WARNING

Please read and understand these instructions completely before installation to avoid possible injury, or damage to the accessory or vehicle.

### NOTICE:

Installation of this kit requires a torque wrench and should be performed by an authorized Yamaha dealer or a qualified mechanic.

### WARRANTY INFORMATION:

In the United States, see your Yamaha dealer for a copy of the Yamaha Genuine Parts and Accessories Limited Warranty.

### DEALER OR INSTALLER:

These instructions contain important information for future reference and *must* be given to the customer.

### PARTS LIST:

No.	Part Number	Description	Qty
--	B4J-F11D0-V0	Rock Slider Kit	--
①	-	Left Rock Slider	1
②	-	Right Rock Slider	1
③	B4J-F171V-V0	M10x25mm Flanged Bolt	4
④	97017-06020	M6x20mm Hex Head Bolt	6
⑤	-	Caution Label	2
⑥	92907-06200	M6 Flat Washer	6
⑦	92902-10200	M10 Flat Washer	4
⑧	B4J-F1459-V0	Spacer	2
⑨	B4M-F1279-V0	Blind Plug	2
⑩	BG4-F1736-T0	Nut Plate	2

\* Part supplied with kit only and not available separately.

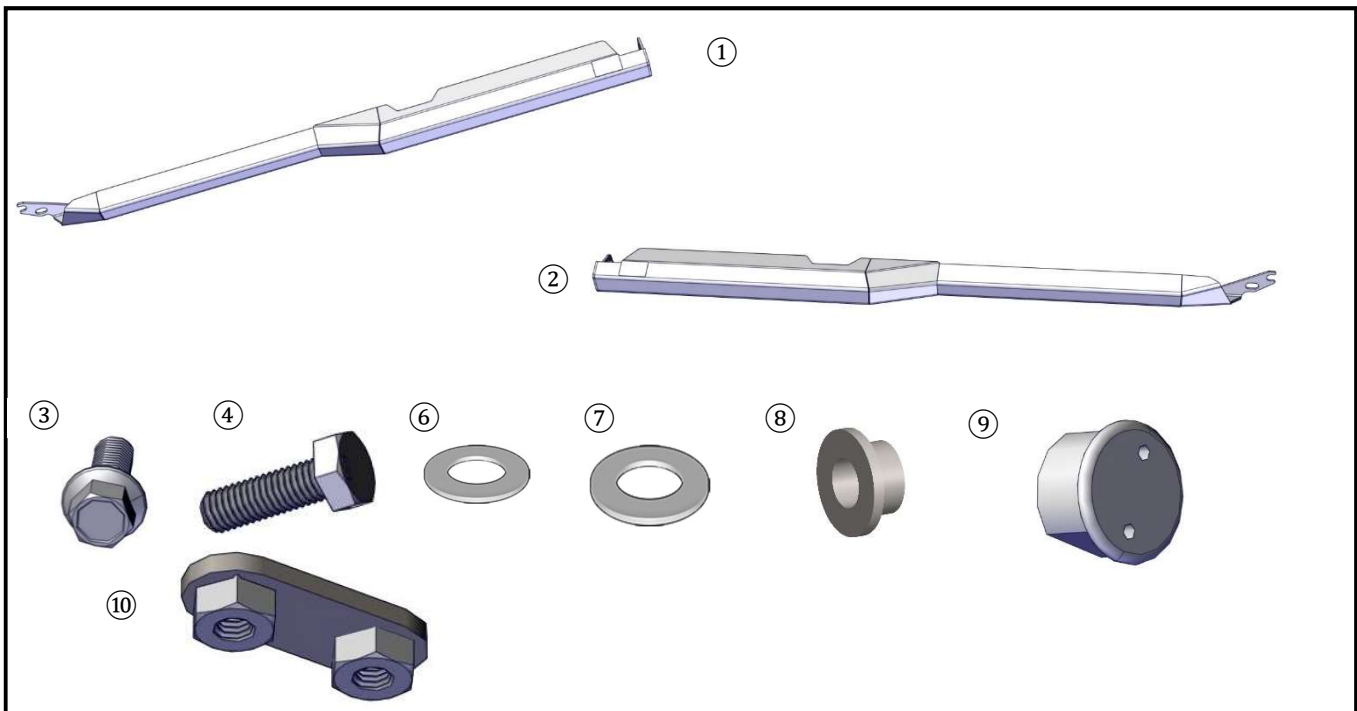

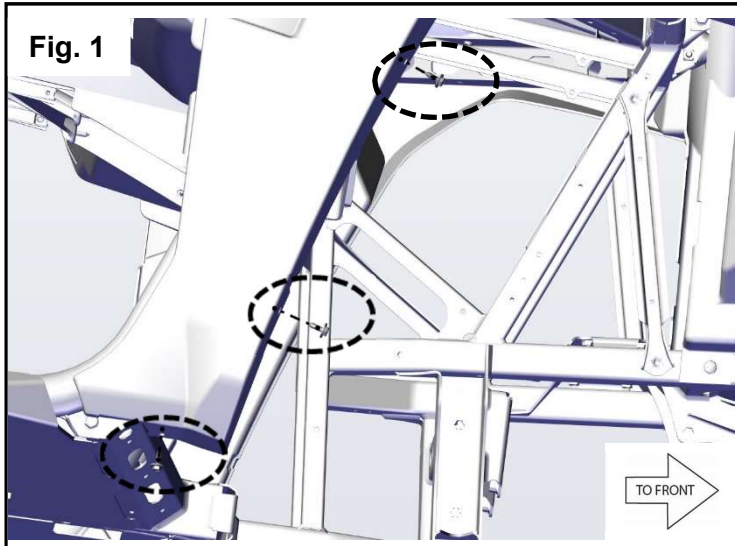

**PREPARATION:**

- Place the vehicle on a secure and level surface.
- Set the parking brake.
- Clean the mount surfaces before beginning installation.

**PARTS REMOVAL:**

1. Loosen both front pillar guards and retain all hardware for reuse. There are three bolts on each side. (Fig. 1)
2. Loosen both front mudguards, there are four bolts in the inner fender area and one bolt in the foot well on each side. Retain all hardware for reuse. (Fig. 2 and 3)

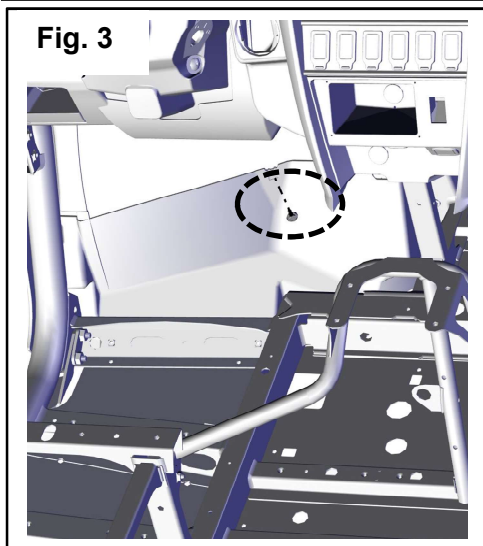
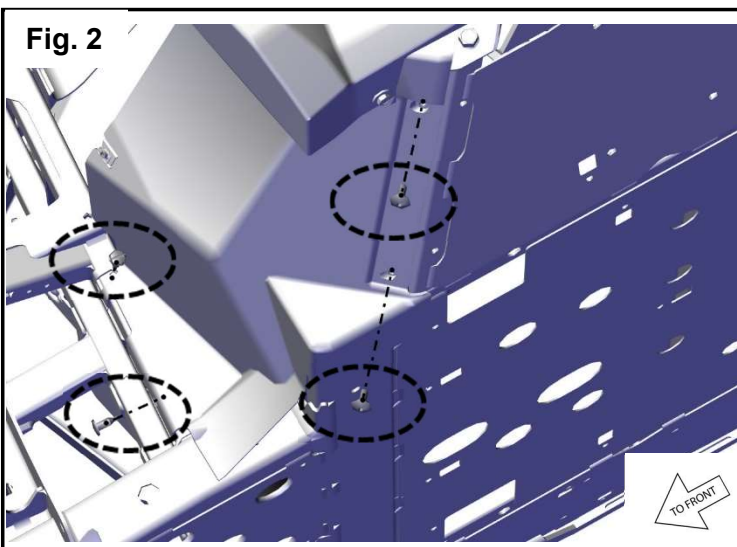

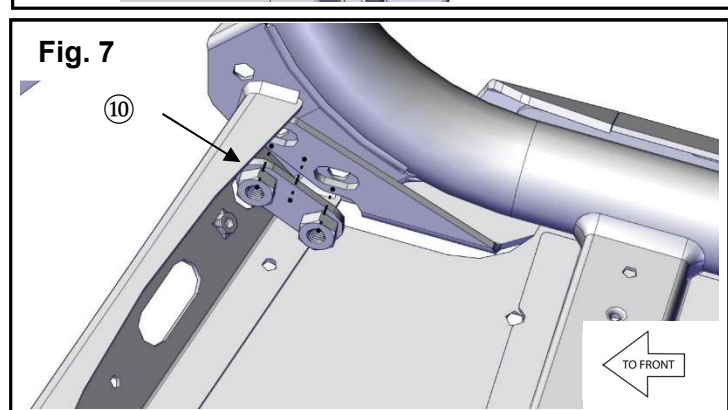
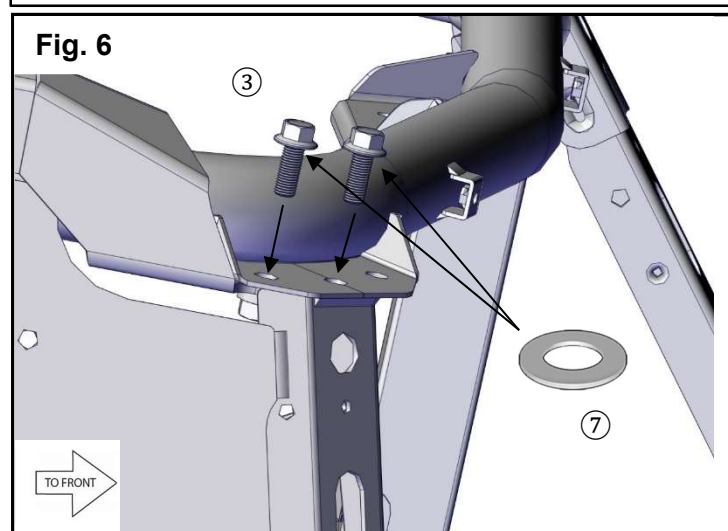
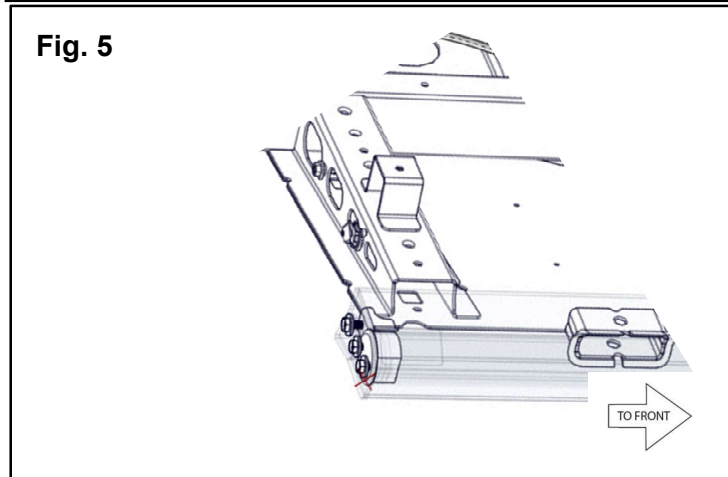
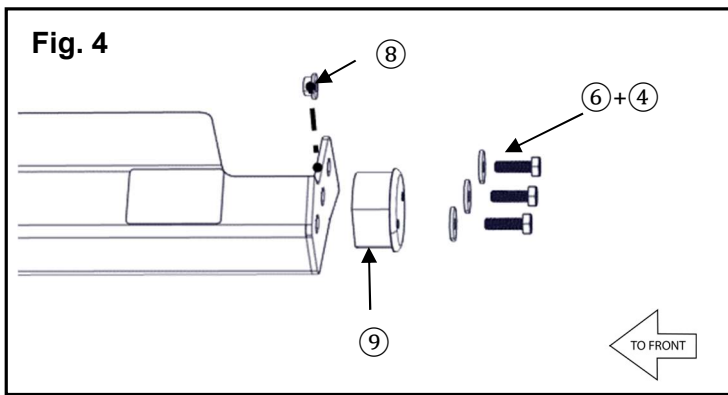

## INSTALLATION:

1. Remove the end cap and the button head bolt in the side of the frame so the rear hardware can be installed.
2. Insert (8) Spacer through the slot in the rear bodywork plastic and insert the (9) Blind Plug into the frame with the holes horizontal to the ground. Slide the (1) Left Rock Slider over the mounting holes and into the front frame. (Fig. 4 and 7)
3. Thread three (4) M6x20mm Hex Head Bolts and three (6) M6 Flat Washers into the rear of the (1) Left Rock Slider. The two in the (9) Blind Plug are torqued to 10 Nm (1.0 kg-m or 7.3 lb-ft). The inner (4) M6x20mm Hex Head Bolt is torqued to 5 Nm (0.5 kg-m or 3.6 lb-ft) (Fig. 5)
4. Align the (1) Left Rock Slider on the front left side of the vehicle. Insert two (3) M10x25mm Flanged Bolts and two (7) M10 Flat Washers through the frame and through the (1) Left Rock Slider. (Fig. 6)
5. Just behind the front wheel, hold the (10) Nut Plate against the inside tab on the (1) Left Rock Slider in the front. Thread the two (3) M10x25mm Flanged Bolts and two (7) M10 Flat Washers into the (10) Nut Plate. (Fig. 7 and Fig. 8)
6. Torque the two (3) M10x25mm Flanged Bolt to 47 Nm
7. Repeat Steps 1 through 5 for the other side of the vehicle for (2) Right Rock Slider.
8. Reinstall the Front Mudguards and Front Pillar Guards loosen in the beginning. Refer to the Service Manual for torque settings on these parts.

**Fig. 8**

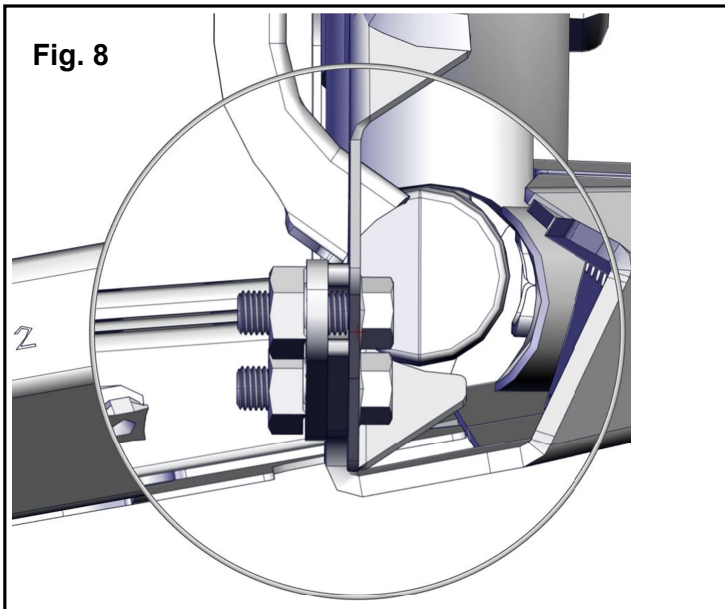

**MAINTENANCE:**

Periodically, check torque on all hardware. If loose hardware is found, re-torque to specification.

**CARE AND CLEANING:**

Clean painted metal parts with a clean soft cloth and mild soap and water solution. Rinse and dry.

**CUSTOMER SERVICE:**

For further information see your Yamaha dealer.

**ESTIMATED TIME TO INSTALL: 1 HRS.**